

# SHIMANO®

## 1987 REPAIR MANUAL

Shimano American Corporation, One Shimano Dr.  
Irvine, CA 92718

### TO ORDER:

This reel belongs to the "Rear Drag" series  
Please order parts using the abbreviation  
"RD" and the part number.

※ Please look here for "S" mark here  
(e.g. 87<sup>S</sup> (KB) - JAPAN)

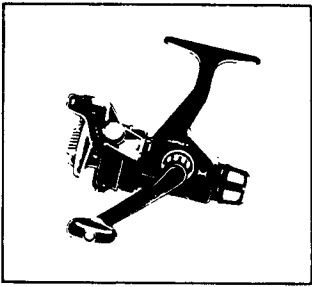

### EXPLODED PARTS VIEW

TX110 Plus

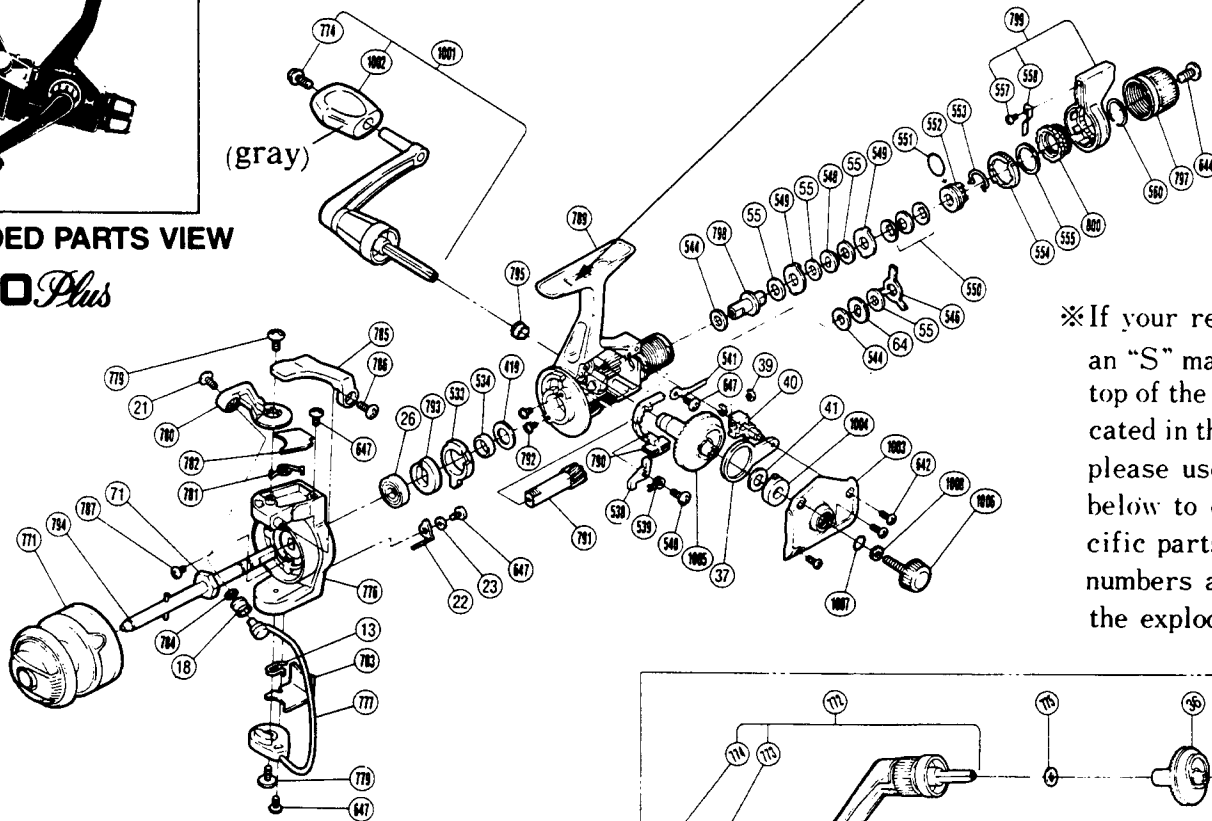

※ If your reel does not  
an "S" mark molded on  
top of the reel foot as  
indicated in the exploded  
view, please use the parts  
listed below to order these  
specific parts. All other  
part numbers are as shown  
in the exploded view.

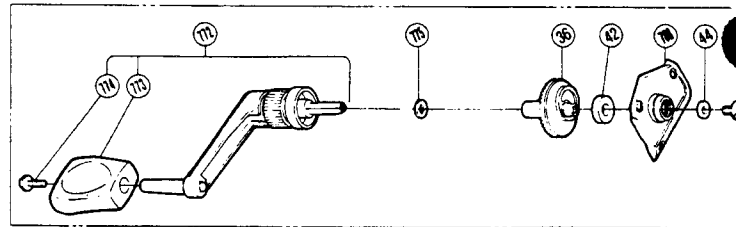

### PARTS LIST

#### PART # DESCRIPTION

- 13. Lever Spring
- 18. Line Roller
- 21. Line Roller Screw (orig. 778)
- 22. Bail Trip Lever
- 23. Trip Lever Spacer
- 26. Ball Bearing
- 36. Drive Gear
- 37. Oscillating Arm
- 39. "C" Lock
- 40. Oscillating Block
- 41. Drive Gear Washer
- 42. Bushing A
- 44. Handle Lock Washer
- 45. Handle Lock Screw (Originally 796)
- 46A. Handle Screw Cap
- 55. Drag Washer "C,"
- 64. Click Gear
- 71. Rotor Nut
- 419. Bushing Washer
- 533. Anti-Reverse Lock Out
- 534. Pinion Spacer
- 538. Anti-Reverse Pawl
- 539. Anti-Reverse Pawl Spring
- 540. Anti-Reverse Pawl Screw
- 541. Drag Click
- 544. Drag Washer "C<sub>2</sub>"

#### PART # DESCRIPTION

- 546. Eared Washer "B<sub>F</sub>"
- 548. Key Washer "A"
- 549. Eared Washer "B"
- 550. Coned Disc Springs
- 551. "O" Ring
- 552. Pressure Screw
- 553. Hold Click Spring
- 554. Lever Click Gear
- 555. Fightin' Pressure Screw Washer
- 557. Fightin' Drag Click Screw
- 558. Fightin' Drag Click
- 560. Lever Hold Spring
- 642. Side Cover Screw
- 644. Drag Programmer Screw
- 647. Multi Purpose Screw
- 771. Spool Assembly (Universal)
- 772. Handle
- 773. Handle Knob
- 774. Handle Knob Screw
- 775. Handle Lock Spacer
- 776. Rotor
- 777. Bail Assembly
- 785. Quick-Fire II Trigger
- 786. Trigger Screw
- 787. Nut Lock Screw

#### PART # DESCRIPTION PRICE

- 788. Side Cover 1.25
- 789. Body 3.30
- 790. Anti-Reverse Switch .25
- 791. Pinion Gear 1.85
- 792. Multi Purpose Screw .15
- 793. Anti-Reverse Ratchet .45
- 794. Main Shaft .90
- 795. Bushing B .25
- 797. Drag Programmer .85
- 798. Drag Shaft .45
- 799. Fightin' Drag Lever .65
- 800. Fightin' Pressure Screw .25
- 1001. Handle Assembly ("S" Version) 3.55
- 1002. Handle Knob ("S" Version) .25
- 1003. Side Cover ("S" Version) 1.50
- 1004. Bushing A ("S" Version) .35
- 1005. Drive Gear ("S" Version) 1.00
- 1006. Handle Screw Cap ("S" Version) .75
- 1007. Lock Washer Retainer ("S" Version) .15
- 1008. Handle Lock Washer ("S" Version) .15